

BILL OF MATERIAL

LOT #/REV	QUAN	MARK	MATERIAL DESCRIPTION	FT.	IN.	REMARKS
ALL WIDE FLANGE			A992		U.N.O.	
ALL OTHER ROLLED SECTIONS			A36		U.N.O.	
ALL HOLLOW STRUCTURAL SECTIONS			A500 GRADE B		U.N.O.	
ALL PIPE SECTIONS			A53 GRADE B		U.N.O.	
CLEAN SPEC:						
HOLES:						
PAINT SPEC:			POWDER COAT			
U.N.O.						

NO	DATE	BY	CHK'D	REV	DESCRIPTION	REVISION DESCRIPTION	APPL SHOP FIELD
1							
2							
3							
4	5/7/3					FOR INSTALLATION	
5	4/27					FOR APPROVAL	

DWG. TITLE: GUARD RAIL SECTION VIEWS

7011 Titan Road, Littleton, CO 80125
 Phone: (303) 791-1333 Fax: (303) 791-6319
 Internet: www.zimkor.com E-Mail: Mail@zimkor.com

7011 Titan Road, Littleton, CO 80125
 Phone: (303) 791-1333 Fax: (303) 791-6319
 Internet: www.zimkor.com E-Mail: Mail@zimkor.com

REF DWG.S.: A-203, REVISED DECK PLAN-2010APR112 Hoffman Deck.PDF

STRUCTURE ASPEN CLUB CONDO UNIT 1427

LOCATION ASPEN, COLORADO

CUSTOMER JOHN OLSEN BUILDERS

ERECTED BY: RMD&F

JOB NO. 1840

DWG NO. 10

ITEM SHEET REV

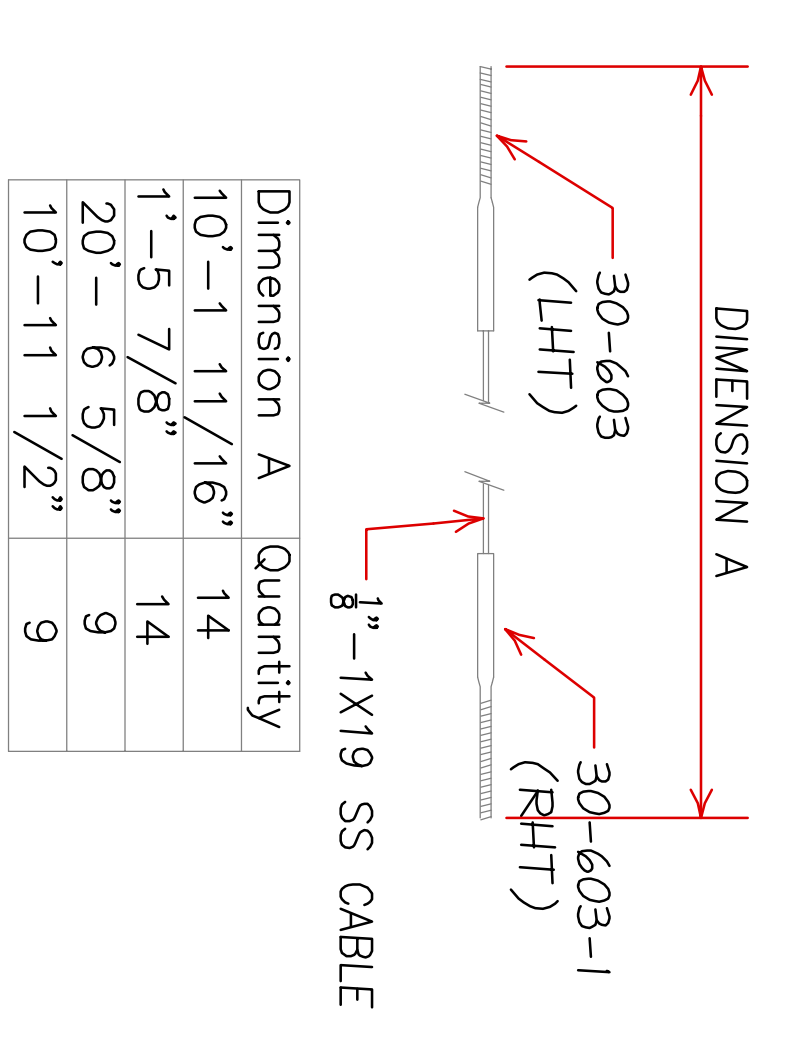
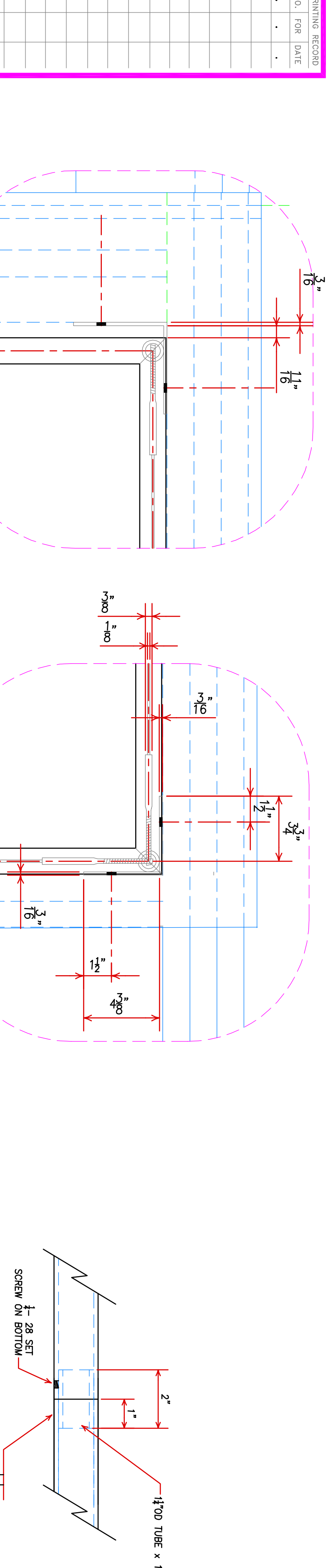
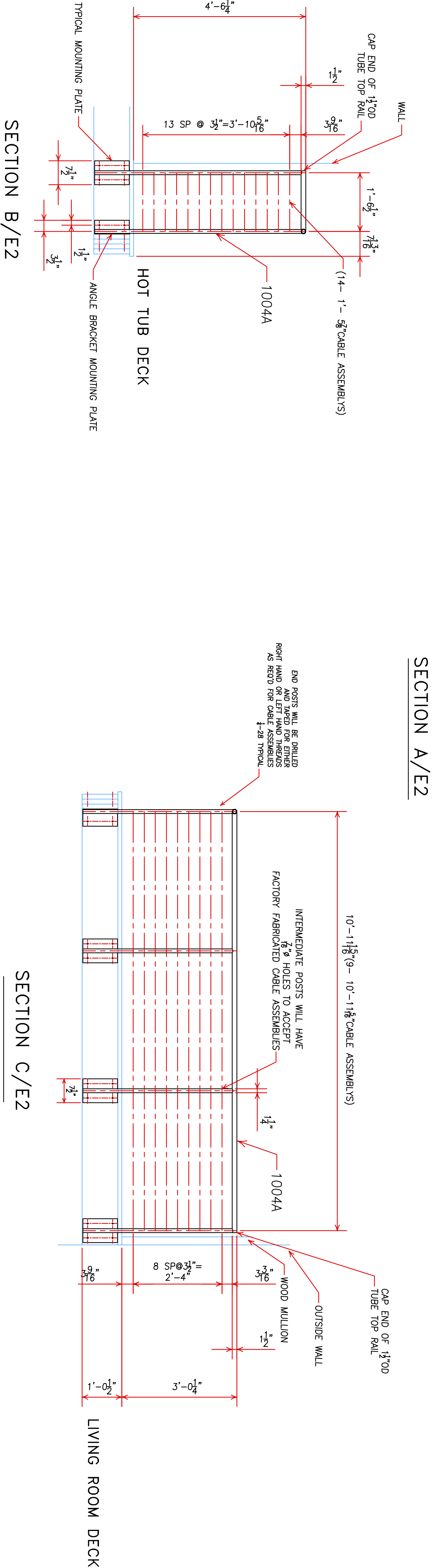
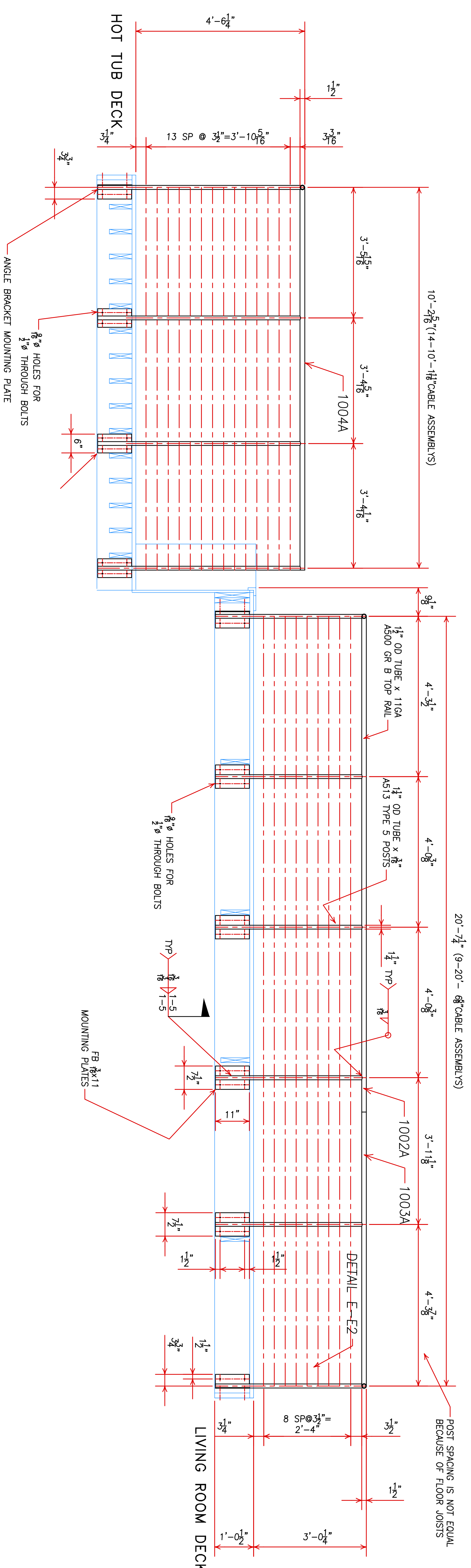

CABLE SCHEDULE FOR CS JOHNSON FACTORY SWAGED CABLES

Dimension A	Quantity
10'-1 11/16"	14
1'-5 7/8"	14
20'-6 5/8"	9
10'-11 1/2"	9

PRINTING RECORD

NO.	FORM	DATE

AutoCAD by Zimkor Industries, Inc.

A B C D E F G H I J K L M N O P Q R S T U V W X Y Z

BILL OF MATERIAL

LOT #REV	QUAN	MARK	MATERIAL DESCRIPTION	LENGTH FT.	IN.	REMARKS
			ALL WIDE FLANGE	A992	U.N.O.	
			ALL OTHER ROLLED SECTIONS	A36	U.N.O.	
			ALL HOLLOW STRUCTURAL SECTIONS	A500 GRADE B	U.N.O.	
			ALL PIPE SECTIONS	A53 GRADE B	U.N.O.	

A B C D E F G H I J K L M N O P Q R S T U V W X Y Z

<p>HOLES: $\frac{9}{16}$</p> <p>CLEAN SPEC:</p>			
<p>PAINT SPEC: POWDER COAT</p>			
U.N.O.			

NO.	MATL.	CHG.	NO.	MATL.	CHG.	NO.	MATL.	CHG.	NO.	MATL.	CHG.
R FIX											
5/23											
R FIX											
4/27											
A											

FOR APPROVAL
FOR INSTALL

REVISION DESCRIPTION
REVISION DESCRIPTION

REV. BY CHK'D
4/27

APPL. SHOP FIELD



7011 Titan Road, Littleton, CO 80125
 Phone: (303) 791-1333 Fax: (303) 791-6319
 Internet: www.zimkor.com E-Mail: Mail@zimkor.com

DWG. TITLE: SINGLE LINE RAIL SECTION VIEWS



REF DWG'S: A-203, REVISED DECK PLAN-2010APRIL12 Hoffman Deck.PDF	JOB NO. 1840
STRUCTURE ASPEN CLUB CONDO UNIT 1427	DWG NO.
LOCATION ASPEN, COLORADO	10
CUSTOMER JOHN OLSEN BUILDERS	E3
ERECTOR BY: RMD&F	REV

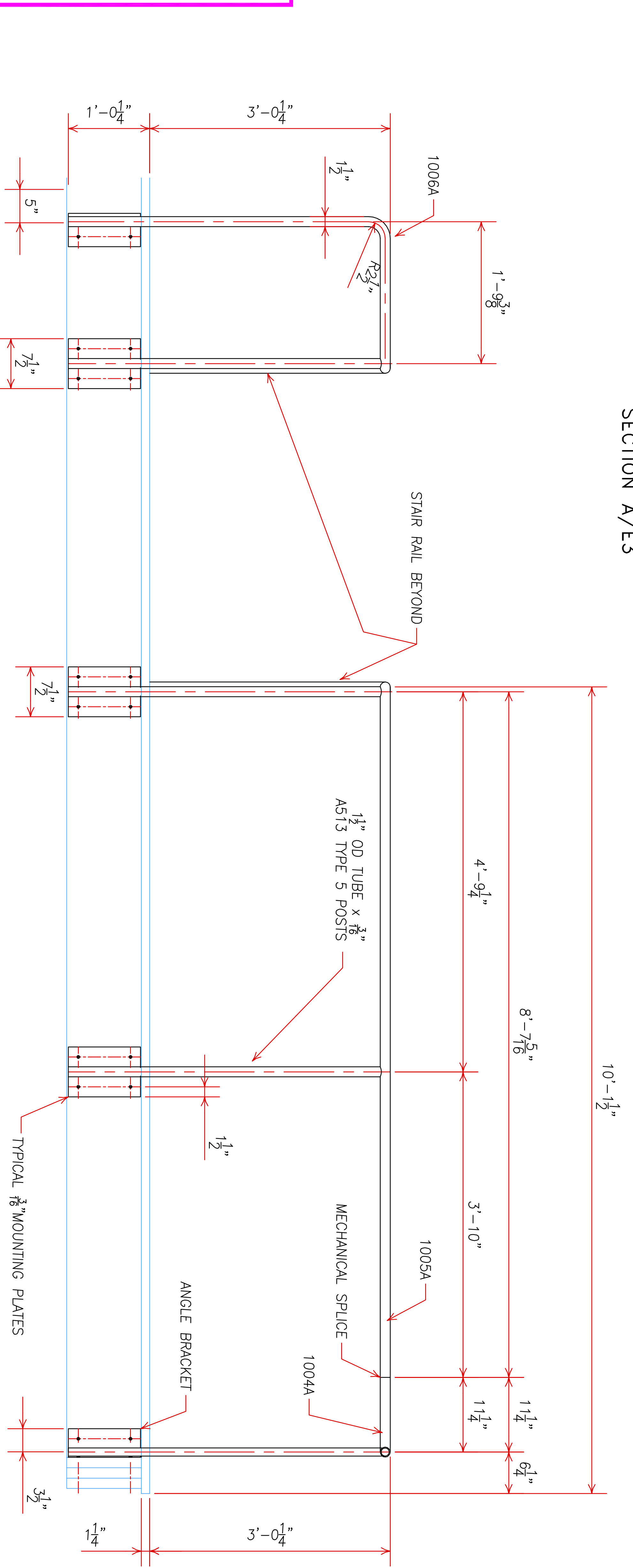
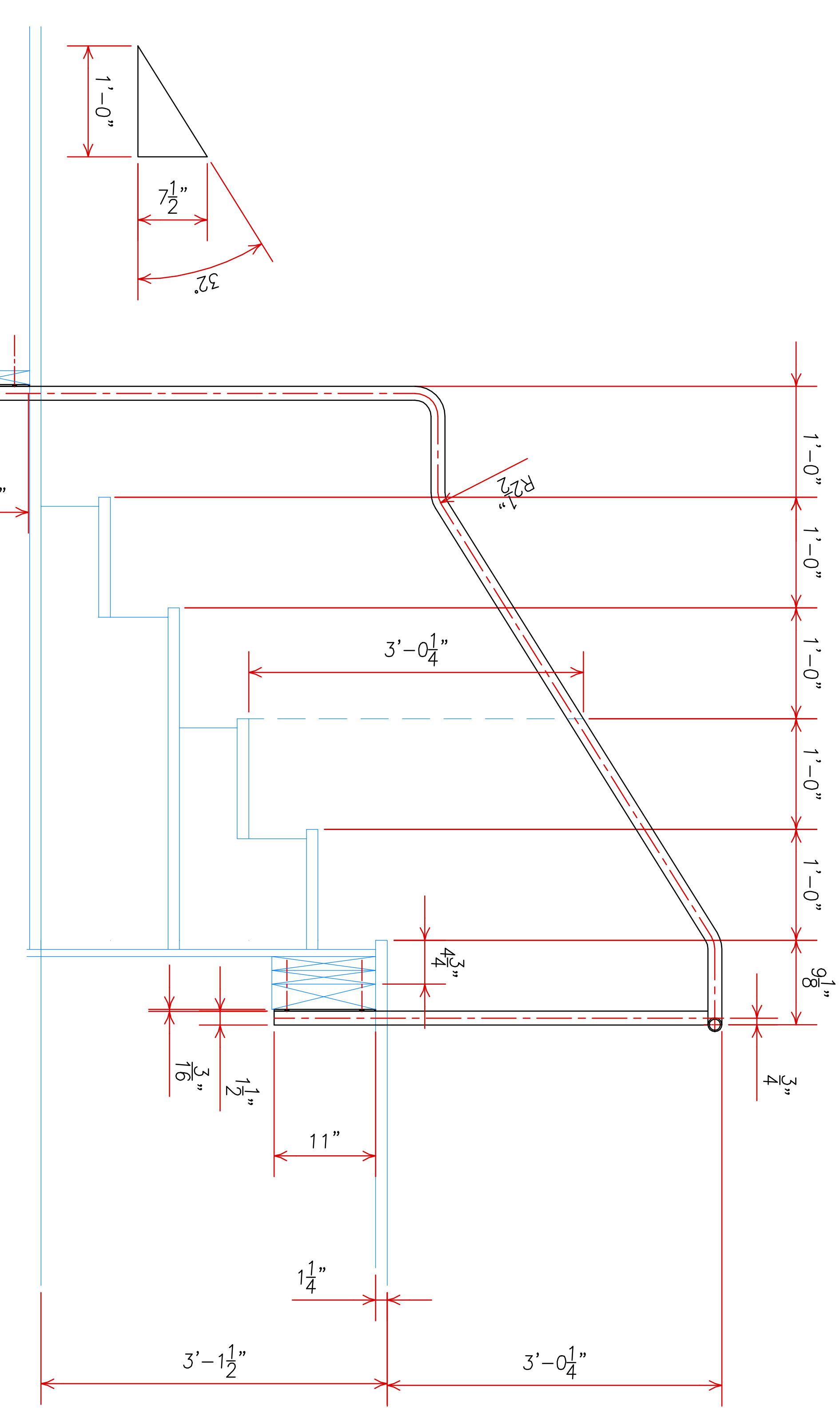

PRINTING RECORD	NO. FOR DATE

AutoCAD by Zimkor Industries, Inc.